

INSTALLATION INFO for DNA P-Y9N24-S2 STAGE 2 KIT

The DNA High Performance filter **P-Y9N24-S2** stage 2 kit is designed to replace the OEM air filter and airbox lid.

1. Remove the ECU from the airbox lid and remove: a) the airbox lid, b) OEM air filter.
2. Install the P-Y9N24-S2 filter. Make sure that the groove underneath the filter is aligned with the rib of the airbox.
3. Install the inox frame that consists of 3 parts (front-rear frame and ECU mount), using the 10x OEM screws of the airbox lid.
4. Install the temp sensor.
5. Install the ECU and secure it in place using the supplied cable ties.

Fuel injection recalibration is recommended in order to take full advantage of the air flow increase and avoid the engine running lean!

Service every 10.000 km. Use the dedicated DNA Service Kit DSK-3001 (sold separately) to clean and re-oil, following the instructions included within the service kit.

The manufacturer and seller make no warranties express or implied which extend beyond the description of the goods contained herein. Any description of this product is for the purpose of identifying it and shall not be deemed to create an express warranty.

DNA
HIGH PERFORMANCE FILTERS

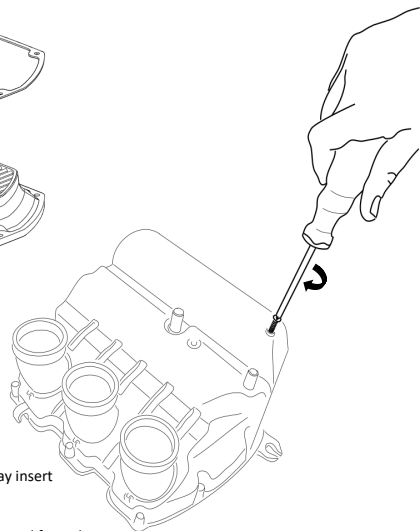
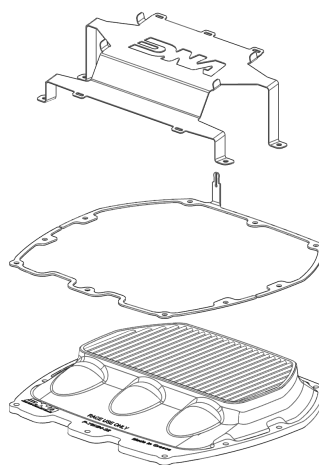

NOTE: It is VERY important to screw the supplied "Drain plug" to the drain hole that it is located at the left-bottom area of the lower part of the airbox, otherwise dust or debris may insert to the engine.

CAUTION: The "Drain plug" must be screwed from the outer side of the airbox

•dnafilters.com • facebook.com/dnafilters
•instagram.com/dnafilters • youtube.com/dnafilters
•tiktok.com/@dnafilters • techsupport@dnafilters.com

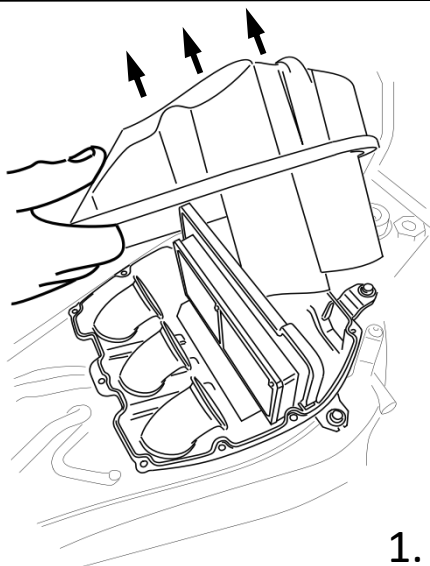

1.

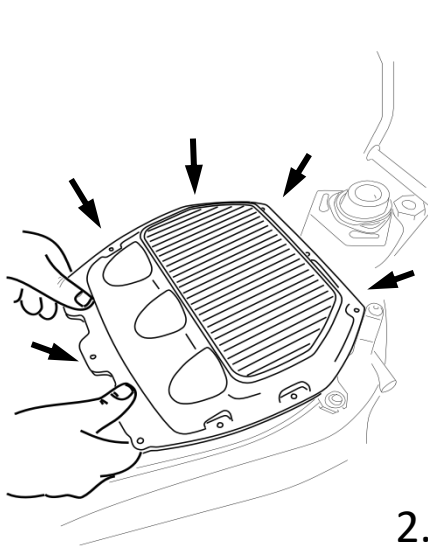

2.

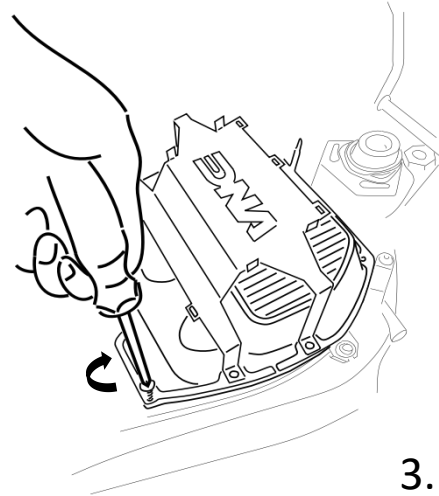

3.

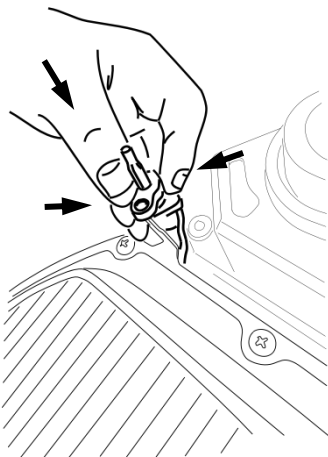

4.

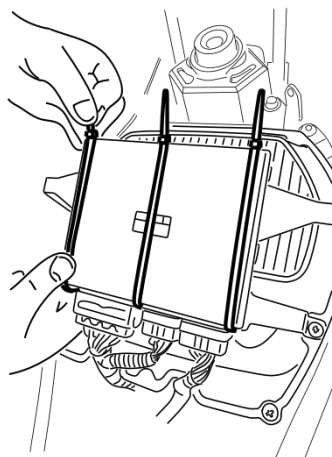

5.